

Best Interior Design for a Home 6,001-7,000 sq. ft.

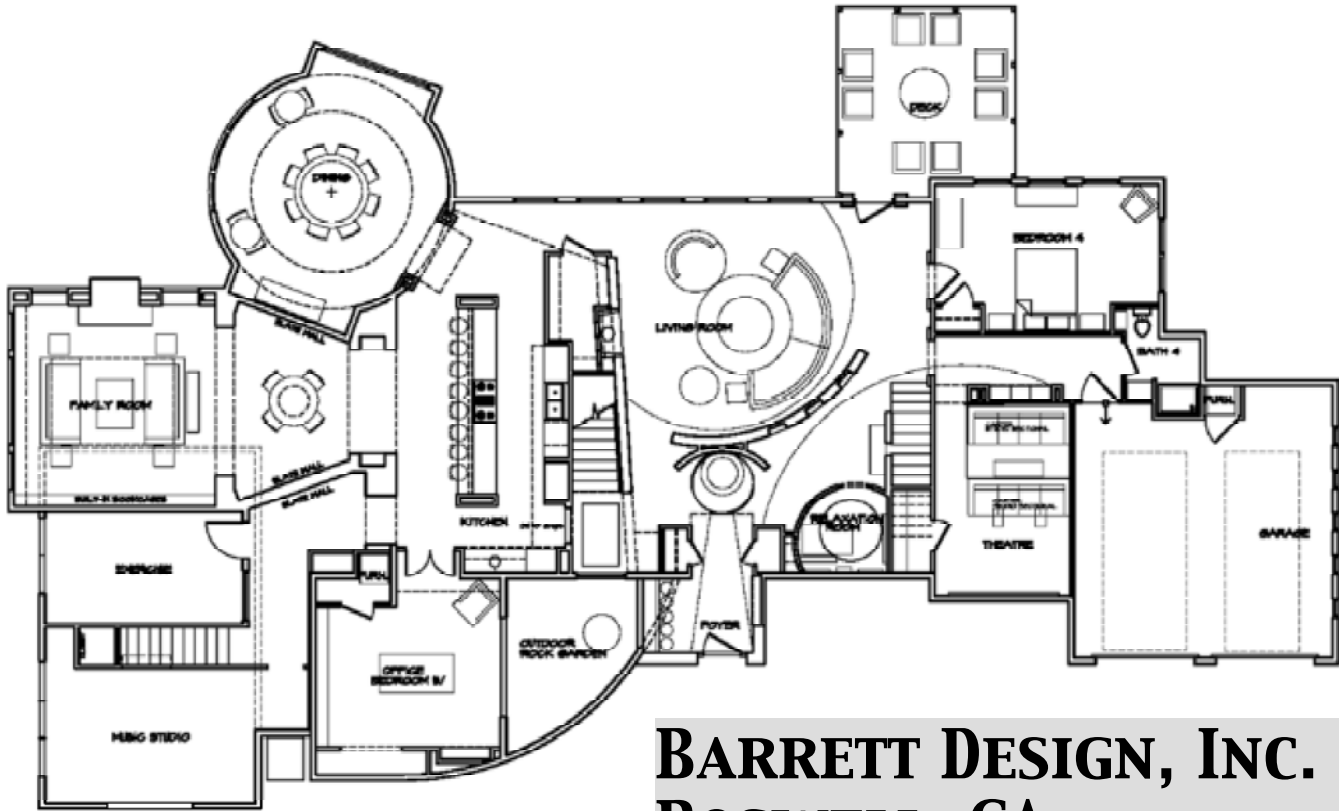

BARRETT DESIGN, INC. ROSWELL, GA

Product Name: Spring Creek
Photographer: Kyle Barrett

Spring Creek was designed by an architect as her own personal residence. Common living areas in the home are on the main floor and were designed for the family to be together. Bedrooms and personal spaces are on the upper floor with 3 separate staircases leading to the girls' wing, the boys' wing and the master wing. Secret passageways interconnect the spaces while maintaining the feeling of a private retreat. The overall palette creates synergy between the exterior of the home and the interior environment. With large expanses of glass the boundaries between exterior and interior blur. Shimmering silk draperies and soft velvet furnishings play off diamond polished concrete floors that contain fossilized leaf imprints. Murano glass beaded walls bring in the sparkle of the natural quartz found in abundance on the site, while soft, natural colored wall coverings on curving forms give the feeling that the interior space was carved out of stone. Fiber optics embedded in the walls give soft twinkle to the living area, while strands of crystal bubbles hang from the ceiling. A relaxation room induces a calming response through use of a multi-sensory environment.

